

### PERFORMANCE SPECIFICATION FOR BATTERY TYPE FGC 23505

Nominal Voltage	12 Volts
Nominal Capacity	20 hour rate @ 1.75 A 25°C _____ 35 Ah
	5 hour rate @ 5.6 A _____ 28 Ah
	1 hour rate @ 21 A _____ 21 Ah
	1 C @ 35 A _____ 17.5 Ah
Dimensions (LxWxH, mm)	198 x 132 x 170, TH 170
Approximate weight	12.7 Kg
Energy Density	94.53 Wh/l
Specific Energy	27.94 Wh/kg
Internal Resistance (Fully charged battery)	8 mΩ
Max discharge current in 1 min discharge	210 A
Max discharge current in 5 sec discharge	320 A
Recommended charging voltage (@20°C)	floating use: 13,5-13,8 Vcyclic use: 14,4-15,0 V
Thermal compensation factor	floating use: -18mV/°Ccyclic use: -30mV/°C
Maximum charging current	10.5 A
Terminals	Threaded inserted M5
Torques	4Nm
Vibration Test	
(2000 cycles/min, 2,55 mm excursion, 2 hrs)	No loss in capacity or performance
Shelf life (% of nominal capacity at 20°C)	1 Month _____ 97%
	3 months _____ 91%
	6 months _____ 83%
Storage temperature	-20°C to 40°C
Operative temperature range	Charge _____ 0° C to 40°C
	Discharge _____ -20°C to 50°C
Case material	Acrylonitrile-Butadiene-Styrene
	Standard Case: according to UL-94 HB
	Also available: according to UL-94 VO
Life expectancy (cyclic use)	more than 500 cycles at 50% depth of discharge

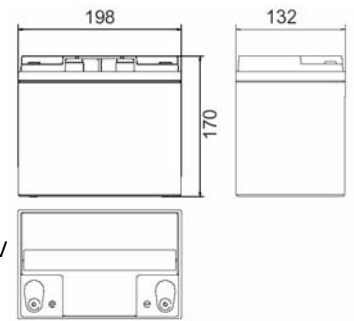

Battery dimensions (mm)

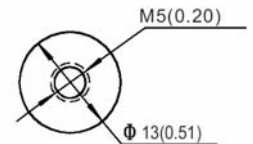

Terminal type

### CONSTANT POWER DISCHARGE TABLE (WATT)

TIME	5'	10'	15'	20'	30'	45'	1h	2h	3h	5h	10h	20h
<b>1,8V/Cell</b>	159	123	104	89.6	69.1	50.6	41.5	23	16.7	11	6.37	3.45
<b>1,75V/Cell</b>	175	131	109	90.5	69.8	51.2	42.1	23.9	17.4	11.4	6.37	3.5
<b>1,7V/Cell</b>	187	142	114	94,9	72.3	51.9	42.8	24.5	17.9	11.7	6.41	3.5
<b>1,67V/Cell</b>	195	147	116	96	73.2	52.3	43.1	24.8	18	12	6.44	3.54
<b>1,6V/Cell</b>	208	152	118	97.5	73.7	53.1	43.4	25.2	18.3	12.2	6.48	3.57

### CONSTANT CURRENT DISCHARGE TABLE (AMPERE)

TIME	5'	10'	15'	20'	30'	45'	1h	2h	3h	5h	10h	20h
<b>1,8V/Cell</b>	103	75.3	53.9	46.6	35	27.3	21.4	12.1	8.58	5.53	3.26	1.71
<b>1,75V/Cell</b>	110	79.5	57.1	48.7	36.8	28.2	21.7	12.4	8.86	5.85	3.29	1.75
<b>1,7V/Cell</b>	119	83.7	64.4	50.4	38.2	28.4	22.4	12.6	9	5.95	3.36	1.8
<b>1,67V/Cell</b>	123	85.8	66.2	51.8	38.5	28.8	23.1	13	9.14	6.09	3.43	1.82
<b>1,6V/Cell</b>	129	87.9	67.2	52.9	40.3	29.3	23.5	13.2	9.42	6.23	3.51	1.85

### DISCHARGE TIME VS DISCHARGE CURRENT

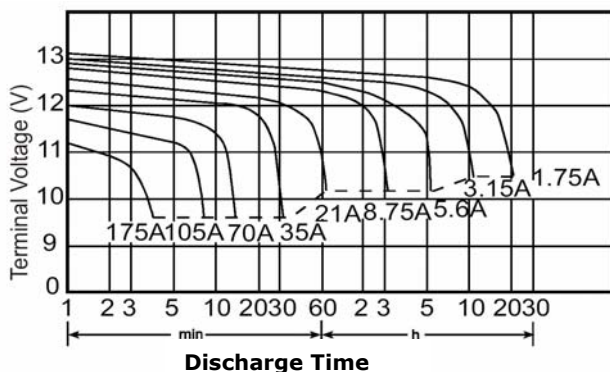

### LIFETIME IN CYCLIC USE

